

SAN DIEGO



HOTEL DEL CORONADO

CALIFORNIA



Located on 28 oceanfront acres on the island of Coronado, the legendary Hotel del Coronado is San Diego's premier meeting destination. The Del offers 65,000 square feet of meeting space that seamlessly blends Victorian elegance with up-to-the-minute technology. The variety of unique indoor, outdoor and oceanfront settings combine to create memorable events, from meetings and conferences to retreats and team-building programs.

In 2007, this National Landmark unveiled over \$150 million in luxury enhancements including: a world-class Spa with 21 treatment rooms, an expansive private terrace and vanishing edge pool overlooking the Pacific; a brand new state-of-the-art Fitness Center and several exciting restaurants and upscale shops. Also, debuting was Beach Village, which features 78 exclusive ocean view guestrooms and suites, a private enclave with pools and hot tubs, front desk and concierge service and access to all of the resort's amenities. The guestrooms in the contemporary Ocean Towers and California Cabanas were also completely renovated to reflect the resort's ocean-inspired setting. 1500 OCEAN, the signature restaurant, featuring Southland coastal cuisine, premiered in May 2006 and was voted 'best new restaurant' by *San Diego Magazine*.

AWARDS & HONORS

Meetings & Conventions

- Hall of Fame
- Gold Key Award

Successful Meetings

- Pinnacle Award
- Best Hotel in the Western United States

Corporate Meetings & Incentives

- Paragon Award
- Award of Excellence

Association Meetings

- Inner Circle Award

Incentive Magazine

- Platinum Partner

Medical Meetings Magazine

- Merit and Distinction Award

Meeting News Magazine

- Planner's Choice Award

Sales & Marketing Management Magazine

- Executive Choice Award

Meetings in the West Magazine

- Best of the West

USA Today

- Top 10 Resorts in the World
- Top 10 Beach Icons

Travel + Leisure

- 500 Greatest Hotels in the World
- Top 100 U.S. Hotels

Wall Street Journal

- America's Best Beaches

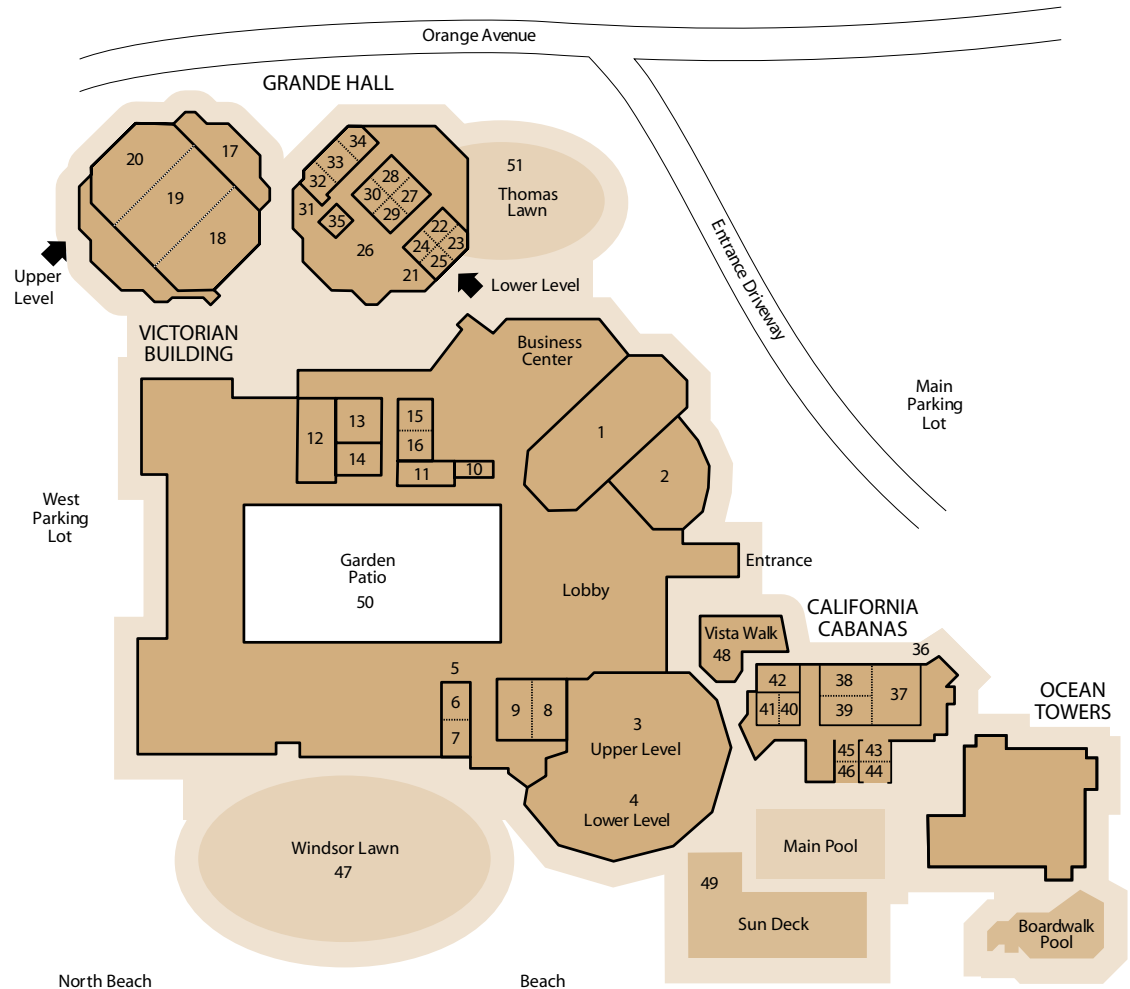

VICTORIAN BUILDING

- Crown
- Coronet
- Ballroom
- Carousel
- Windsor Complex
- Windsor
- Embassy
- Crystal
- Continental
- Executive Room
- Garden Room
- Hanover
- Stuart
- Tudor
- Kent
- York

GRANDE HALL

- Grande Hall Foyer
- Empress
- Regent
- Viceroy
- Spreckels Complex
- Spreckels Salon A
- Spreckels Salon B
- Spreckels Salon C
- Spreckels Salon D
- Wilder Complex
- Wilder Salon E
- Wilder Salon F
- Wilder Salon G
- Wilder Salon H
- Edison Complex
- Edison Salon I
- Edison Salon J
- Edison Salon K
- Board Room

CALIFORNIA CABANAS

- Tropics
- Sea Breeze
- Palm
- Sunset
- Strand
- Bayside
- Pointe
- Pacifica
- Tide
- Coastal
- Surf

OUTDOOR VENUES

- Windsor Lawn
- Vista Walk
- Sun Deck
- Garden Patio
- Thomas Lawn



I N D O O R & O U T D O O R M E E T I N G F A C I L I T I E S

Map No.	Conference Room	Square Footage	Dimensions	Ceiling	Classroom	Theater	Conference	U-Shape	Hollow Square	Banquet 6' Rounds Of 10	Banquet 5' Rounds Of 10	Banquet 5' Rounds Of 8
INDOOR VENUES												
1	Crown Room	7,931	51 x 155	30'	472	1048	132	140	152	510	620	496
2	Coronet Room	3,575	57 x 65	25'6"	92	182	48	44	56	120	180	144
3	Ballroom	12,567	126 x 100	30'1"	528	1110	84	68	72	720	720	576
4	Carousel Room	4,965	79 x 79	9'5"	128	288	48	36	48	330	400	320
5	Windsor Complex	1,591	26 x 53	8'1"	80	168	44	48	52	80	100	80
6	Windsor Room	583	20 x 26	8'1"	32	60	20	20	16	30	40	32
7	Embassy Room	1,008	26 x 33	8'1"	40	80	28	24	28	50	60	48
8	Crystal Room	768	24 x 32	9'3"	40	72	28	24	24	50	50	40
9	Continental Room	1,183	32 x 37	9'3"	72	120	28	32	48	60	70	56
	Crystal/Continental Room	1,951	32 x 61	9'3"	124	216	52	52	56	120	120	96
10	Executive Room	390	15 x 31	10'	—	—	17	—	—	—	—	—
11	Garden Room	1,645	33 x 50	8'6"	96	169	36	32	40	110	110	88
12	Hanover Room	1,415	29 x 53	8'4"	60	130	44	20	20	80	80	64
13	Stuart Room	973	28 x 34	9'1"	48	80	28	20	16	60	60	48
14	Tudor Room	508	15 x 31	7'8"	20	40	28	—	—	30	30	24
15	Kent Room	350	17 x 23	8'4"	16	30	20	12	16	20	20	16
16	York Room	346	16 x 23	8'4"	16	30	20	12	16	20	20	16
	York/ Kent Room	696	17 x 46	8'4"	32	63	24	22	26	40	50	40
17	Grande Hall	10,943	87 x 133	22'2"	784	1288	114	124	144	730	920	736
18	Empress Hall	3,488	44 x 89	22'2"	184	342	72	72	80	190	260	208
19	Regent Hall	3,968	44 x 90	22'2"	272	522	80	76	88	210	280	224
20	Viceroy Hall	3,487	44 x 88	22'2"	184	342	72	72	80	190	260	208
	Empress/Regent Hall	7,456	44 x 179	22'2"	528	1056	72	92	112	460	620	496
	Regent/Viceroy Hall	7,455	44 x 178	22'2"	516	1056	84	92	112	460	620	496
21	Spreckles Complex	1,515	35 x 41	7'5"	80	160	36	28	40	60	90	72
22	Spreckles Salon A	325	15 x 22	7'5"	16	33	16	12	16	20	20	16
23	Spreckles Salon B	502	20 x 22	7'5"	20	40	20	12	16	20	20	16
24	Spreckles Salon C	293	15 x 20	7'5"	16	32	16	12	16	20	20	16
25	Spreckles Salon D	394	20 x 20	7'5"	16	40	16	12	16	20	20	16
	Spreckles A/B	830	20 x 44	7'5"	44	66	28	20	24	50	50	40
	Spreckles C/D	687	20 x 40	7'5"	36	60	28	20	24	50	50	40
26	Wilder Complex	1,602	40 x 42	7'4"	96	176	32	28	40	80	80	64
27	Wilder Salon E	424	20 x 22	7'4"	24	32	20	12	16	20	20	16
28	Wilder Salon F	425	20 x 22	7'4"	24	30	20	12	16	20	30	24
29	Wilder Salon G	376	20 x 22	7'4"	24	35	20	12	16	20	30	24
30	Wilder Salon H	377	20 x 23	7'4"	24	35	20	12	16	20	30	24
	Wilder E/F	849	20 x 44	7'4"	48	70	28	28	—	50	50	40
	Wilder G/H	753	20 x 45	7'4"	48	48	28	28	32	30	40	32
31	Edison Complex	1,619	27 x 63	7'8"	80	150	52	44	48	80	90	72
32	Edison I	506	27 x 19	7'8"	32	59	20	20	16	20	30	24
33	Edison J	621	27 x 24	7'8"	40	56	20	20	24	40	40	32
34	Edison K	492	27 x 20	7'8"	32	59	20	20	16	20	30	24
	Edison I/J	1,127	27 x 43	7'8"	64	119	36	32	40	50	50	40
	Edison J/K	1,113	27 x 63	7'8"	72	126	36	28	40	50	60	48
35	Board Room	263	15 x 18	7'11"	—	—	10	—	—	—	—	—
36	Tropics	3,974	44 x 88	11'4"	256	490	80	80	96	210	320	256
37	Seabreeze Room	2,167	44 x 49	11'4"	144	240	36	44	56	120	160	128
38	Palm Room	923	22 x 40	11'4"	52	100	32	28	32	40	60	48
39	Sunset Room	884	22 x 40	11'4"	52	88	32	28	32	40	60	48
	Palm/Sunset Room	1,807	44 x 40	11'4"	96	198	36	36	40	120	120	96
40	Strand Room	419	22 x 20	9'11"	24	40	16	12	16	20	30	24
41	Bayside Room	453	22 x 20	9'11"	24	40	16	12	16	20	30	24
	Bayside/Strand Room	873	22 x 40	9'11"	48	96	28	28	32	40	50	40
42	Pointe Room	850	22 x 39	9'10"	52	88	28	28	32	40	50	40
43	Pacifica Room	363	20 x 19	9'7"	16	28	20	12	16	20	20	16
44	Tide Room	370	19 x 19	9'7"	16	40	20	12	16	20	20	16
	Pacifica/Tide Room	733	22 x 38	9'7"	48	49	34	28	24	40	40	36
45	Coastal Room	492	19 x 25	10'	24	69	20	20	24	20	30	24
46	Surf Room	478	18 x 25	10'	32	54	20	20	24	20	30	24
	Coastal/Surf Room	969	37 x 25	10'	52	72	28	28	32	40	60	48
OUTDOOR VENUES												
47	Windsor Lawn	16,956	180 x 120	—	—	—	—	—	—	1,220	1,470	1,176
48	Vista Walk	12,032	—	—	—	—	—	—	—	80	80	64
49	Sundeck	13,140	—	—	—	—	—	—	—	—	—	—
49	Sundeck Back	6,011	—	—	—	—	—	—	—	—	—	—
50	Garden Patio	10,764	—	—	—	—	—	—	—	340	470	376
51	Thomas Lawn	8,000	—	—	—	—	—	—	—	—	—	—

Capacity specifications exclude multimedia, staging, décor, and buffet requirements.

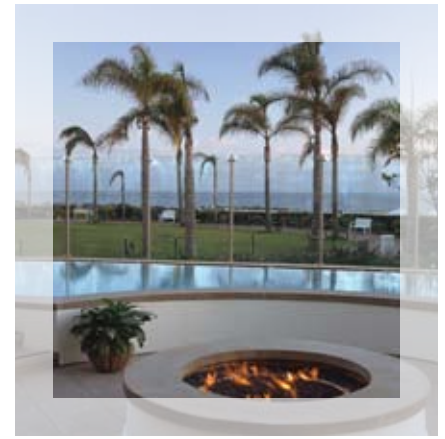

Accommodations

The Del's 757 rooms are located in the Victorian, Ocean Towers and California Cabana Buildings as well as the new Beach Village at The Del. Guestrooms in the Victorian Building reflect the resort's historic charm. Guestrooms in the Ocean Towers and California Cabanas are contemporary in style and reflect the beachside setting. The exclusive beachfront cottages and villas at Beach Village feature the finest luxury amenities including fully-equipped kitchens and gourmet-quality appliances, cozy fireplaces, spa-style baths with soaking tubs, spacious ocean-view balconies, private terraces and much more.

Conference and Meeting Facilities

For all of The Del's historic charms, its 41 meeting rooms are undeniably 21st century, seamlessly integrating every modern technological need into their elegant settings. The resort's 65,000 square feet of meeting space encompasses a wide variety of indoor, outdoor and oceanfront venues. The 12,567-square-foot Ballroom provides a magnificent setting for gatherings of up to 950 with panoramic ocean views, while the contemporary Grande Hall features nearly 12,000 square feet of unobstructed space and multiple connected breakout rooms. The 2,900-square-foot Crown Room has hosted countless banquets for heads of state, and *Wizard of Oz* author L. Frank Baum is credited with designing its unique crown chandeliers. Equally charming, the Windsor Lawn is an elegant choice for social events and welcome receptions.

Technology

All meeting rooms are equipped with high-speed and wireless Internet access and full multimedia capabilities. The audio-visual department provides on-site, state-of-the-art equipment and professional services, including concert-quality audio systems and visual presentation equipment. A full-service Business Center offers complete business support from computer workstations to office supplies to shipping, faxing and copying services.

Spa & Fitness

An array of relaxing and rejuvenating spa treatments are available. Spa at The Del, a new world-class spa includes 21 treatment rooms, hydrotherapy, relaxation areas for men and women and steam rooms. Guests can also unwind at the Spa's expansive private terrace and infinity pool overlooking the magnificent Windsor Lawn and the Pacific Ocean.

The Del's new Fitness Center caters to active guests and features an aerobics/spin/Pilates studio, exercise room, personal training and state-of-the-art weight and cardio-vascular equipment.

Golf

Guests enjoy preferred reservations at more than 80 golf courses in the San Diego area, including the nearby Coronado Golf Course, one of Southern California's finest public courses.

Other Activities

Among the myriad diversions at The Del are sparkling resort pools with private cabanas; a wide array of beach and water activities including beach volleyball, sunset sailing cruises and surfing lessons; bicycle rentals; and a unique variety of distinctive shops and boutiques. Groups with younger guests will find plenty of activities including Tent City Kids' Camp and special spa services, shopping and recreation designed just for teens.

Dining

The Del features seven restaurants including 1500 OCEAN, the new signature dining venue offering Southland Coastal cuisine nightly; Sheerwater, serving breakfast, lunch and dinner in a casual oceanfront setting; and the Crown Room, with an award-winning Sunday brunch. The resort also features several bars, 24-hour room service and seasonal venues. The restaurants and creative culinary team consistently garner top awards including being named "Best Hotel Dining" in San Diego.



HOTEL DEL CORONADO™

1500 ORANGE AVENUE | CORONADO, CA 92118 TEL: (619) 435-6611 (800) HOTEL-DEL FAX: (619) 522-8239 | WWW.HOTELDEL.COM

THE KSL RESORTS COLLECTION ■ KSLRESORTS.COM

HOTEL DEL CORONADO™ ■ LA COSTA RESORT AND SPA® ■ RANCHO LAS PALMAS RESORT & SPA™ ■ VAIL MOUNTAIN LODGE & SPA™ ■ BARTON CREEK RESORT & SPA™ ■ THE HOMESTEAD®

1.866.KSL.7727